



# Standard Gain Horn Antennas

26.3 - 40.0 GHz, 15 dBi



Radiation pattern

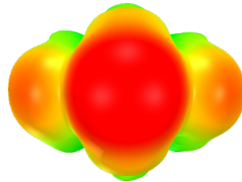

QR code



Hangzhou Multipath Electronics Co., Ltd., Zhejiang, China

## ⚙️ Product specifications

Part number	HA-WR28-15	Polarization	Single linear
Antenna type	Pyamidal horn	Gain [dBi]	15 Typ.
Frequency range [GHz]	26.3 – 40.0	3dB beamwidth [deg]	E-plane: 25 Typ. H-plane: 25 Typ.
Waveguide band	WR28	Cross-polarization isolation [dB]	27 Typ.
Dimensions (H x W x L) [mm; inch]	20.7 x 29.5 x 78.6; 0.82 x 1.16 x 3.10	VSWR	1.15 Typ.
Weight (approx.) [kg; lb]	0.04; 0.088	Impedance [Ohms]	50
Material	Aluminum	RF connector	2.4-Female

## Outline dimensions

### • Assembly dimensional drawing

Multipath Electronics provides complete standard gain horn antennas, forming mounting systems, integrated with (optional) waveguide to coaxial adapters, L type and round mounting brackets. The following figure shows the disassembly diagram of such a system.

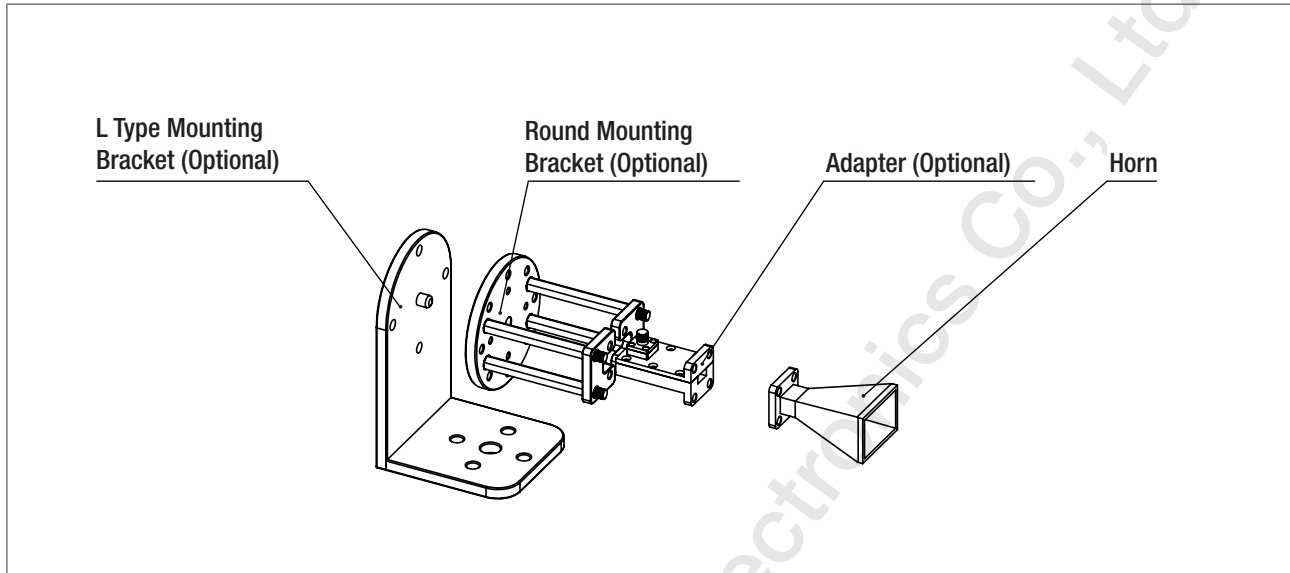

Side view of the mounting system.

Detailed dimensions of the components will be given in subsequent diagrams.

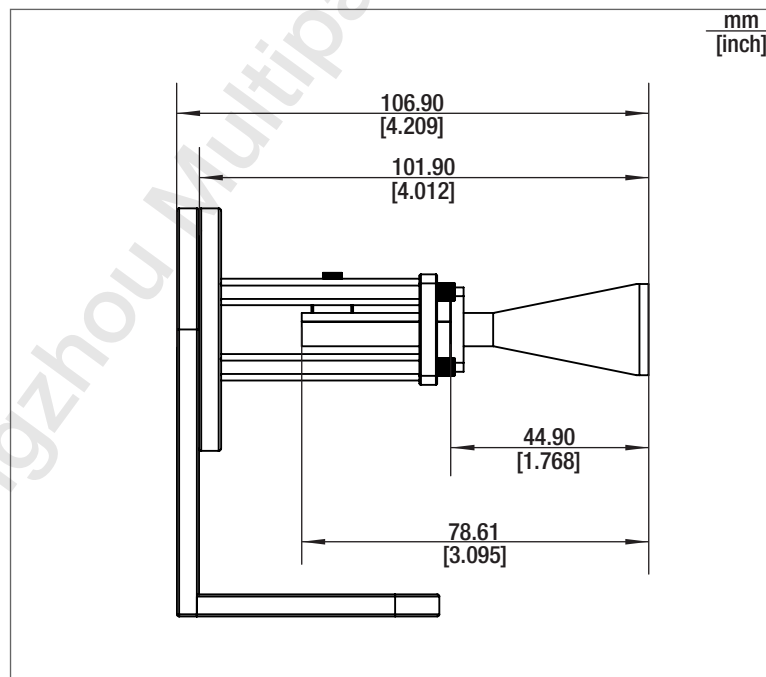

• Dimensional drawing: horn, HA-WR28-15

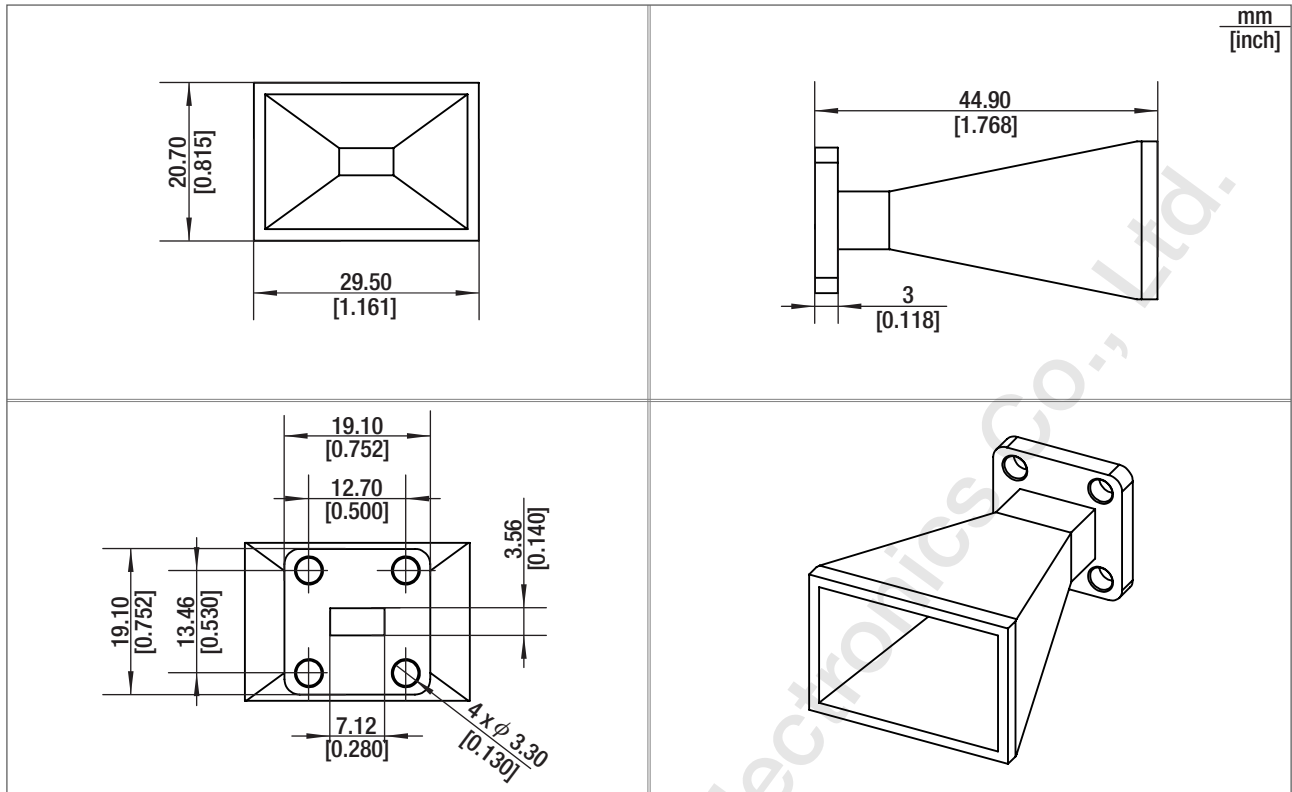

• Dimensional drawing: adapter, WR28-SMA-F (Optional)

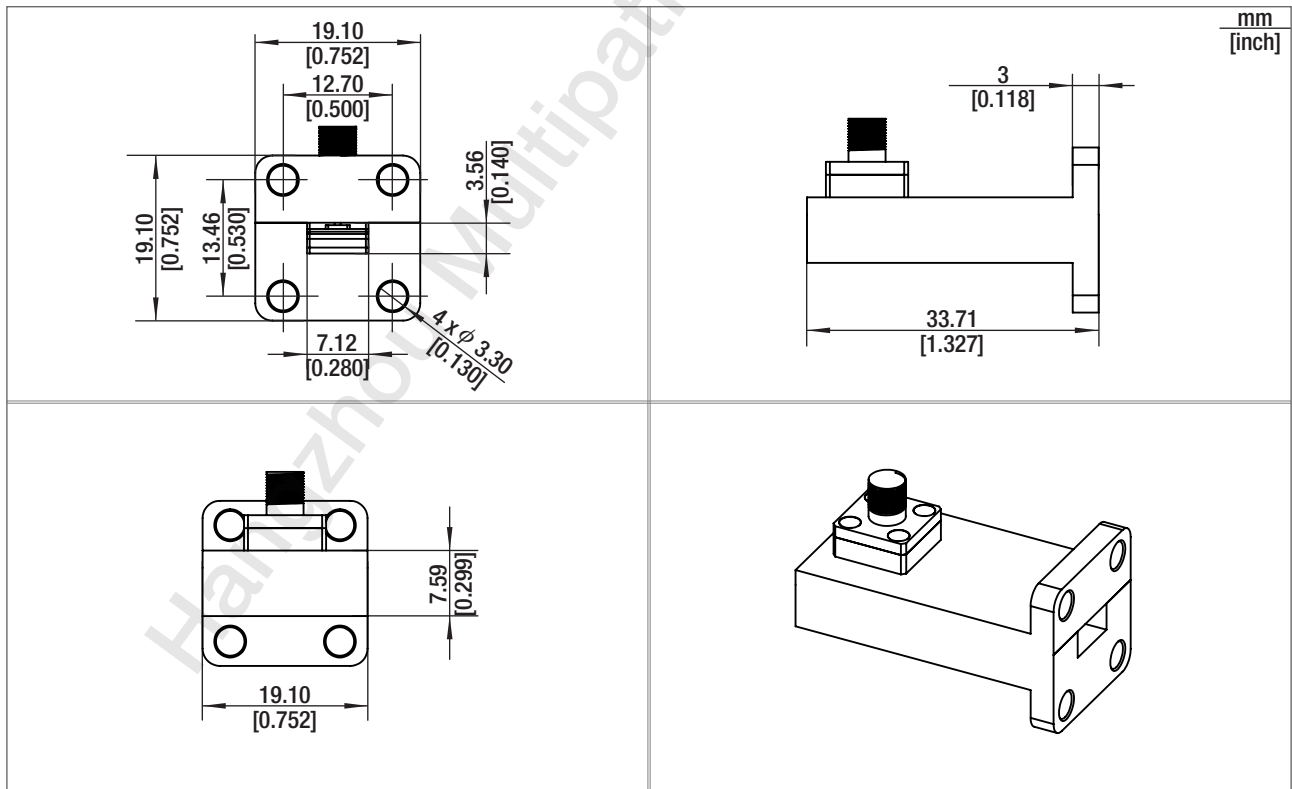

• Dimensional drawing: round mounting bracket (Optional)

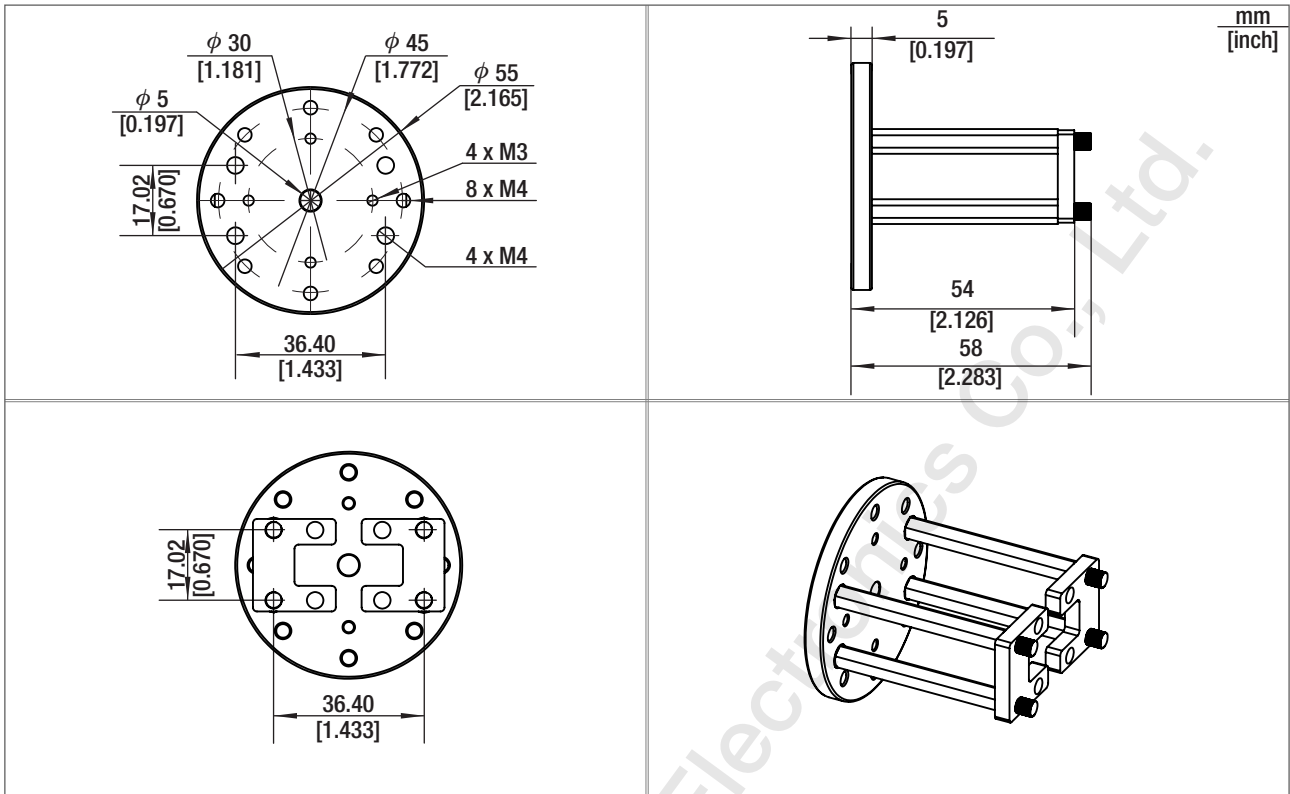

• Dimensional drawing: L type mounting bracket (Optional)

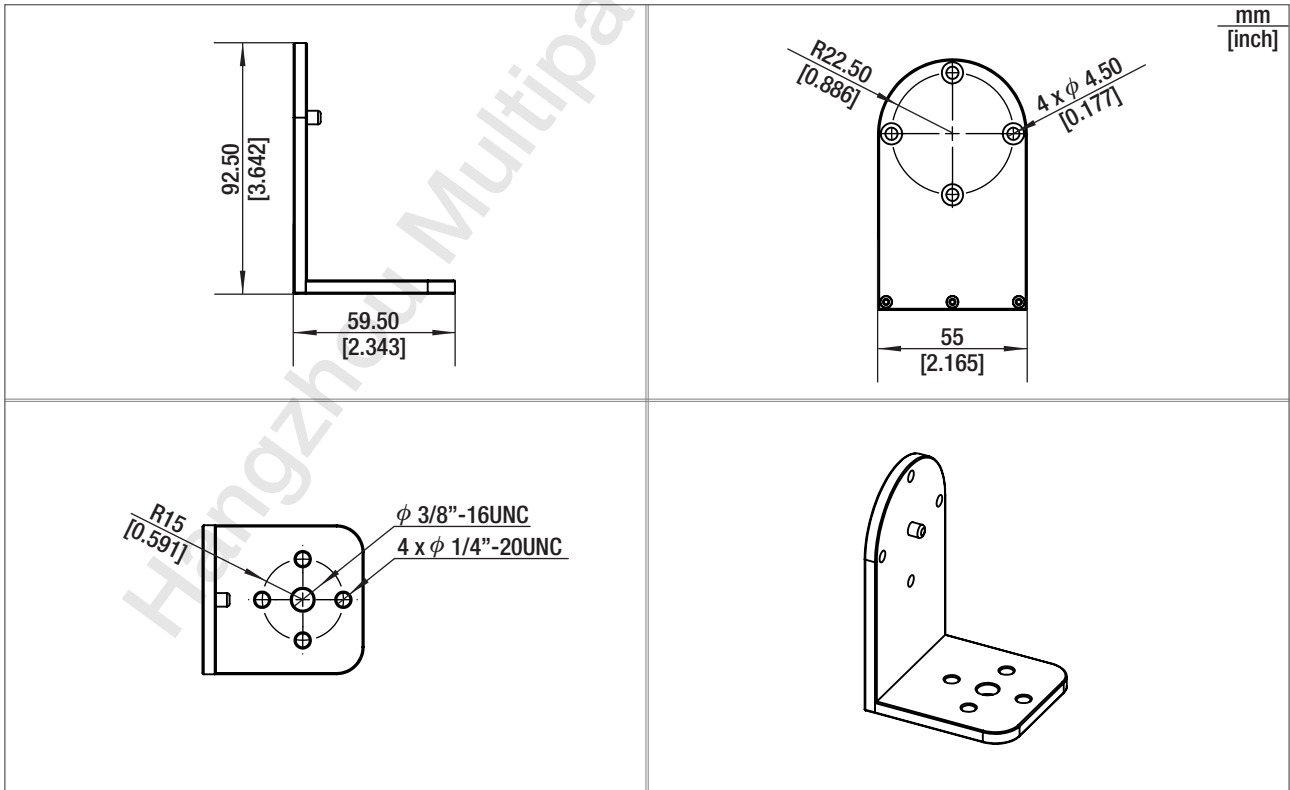

## Electrical characteristics

### Gain & Antenna factor & Cross-polarization isolation & VSWR

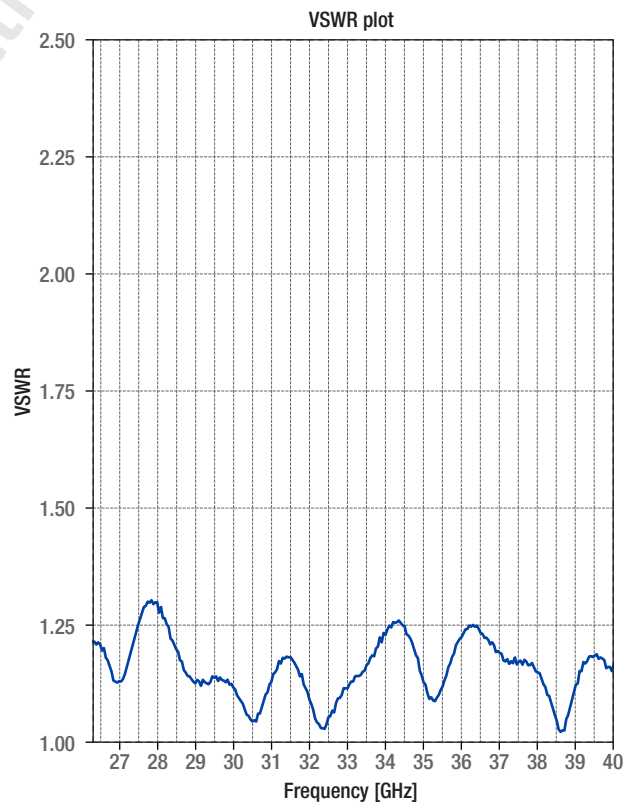
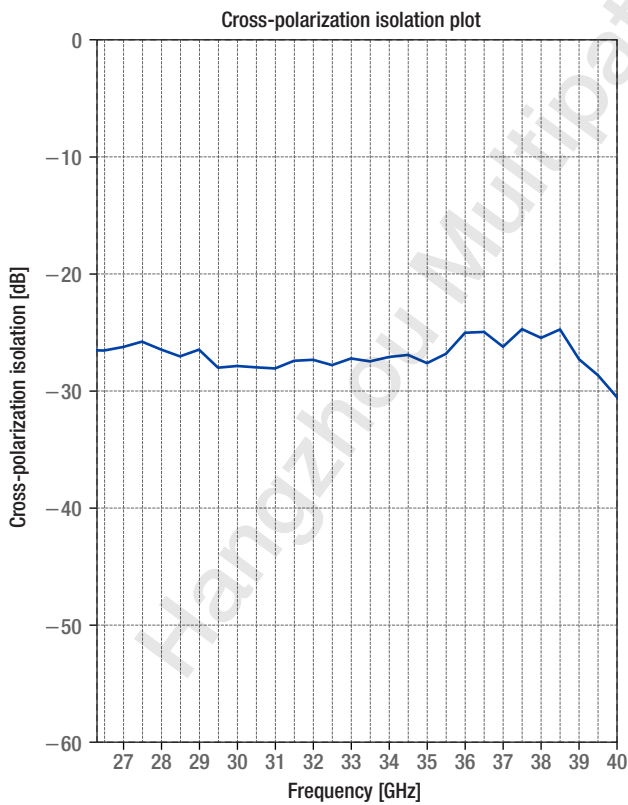
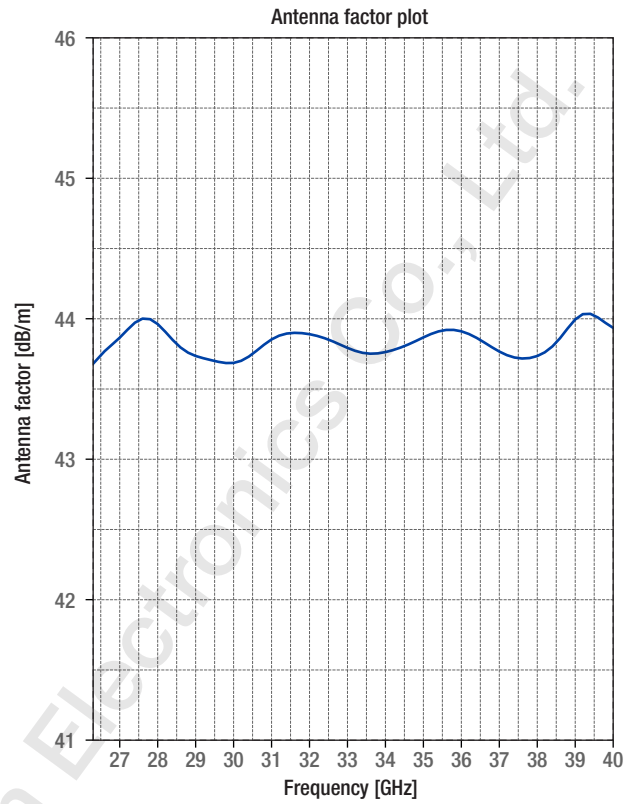
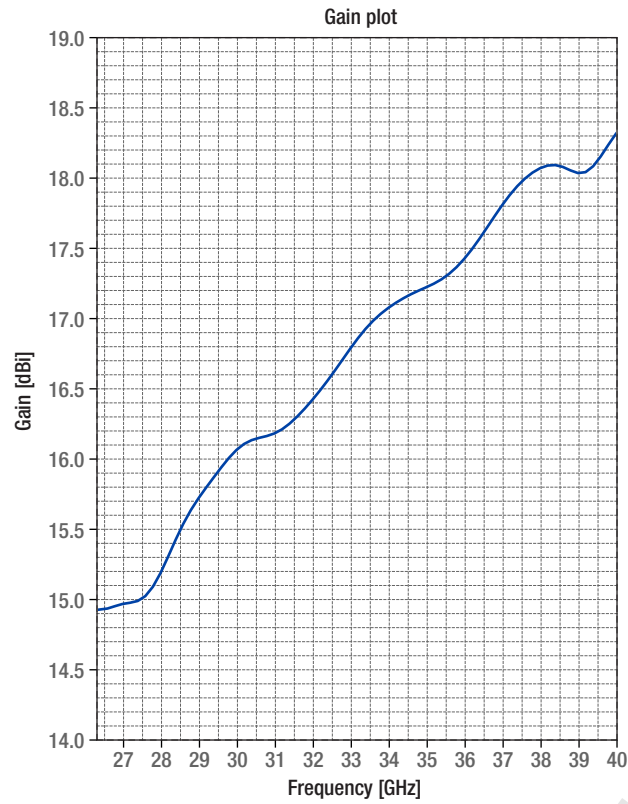

## • Radiation patterns

Patterns @ 26.5 GHz

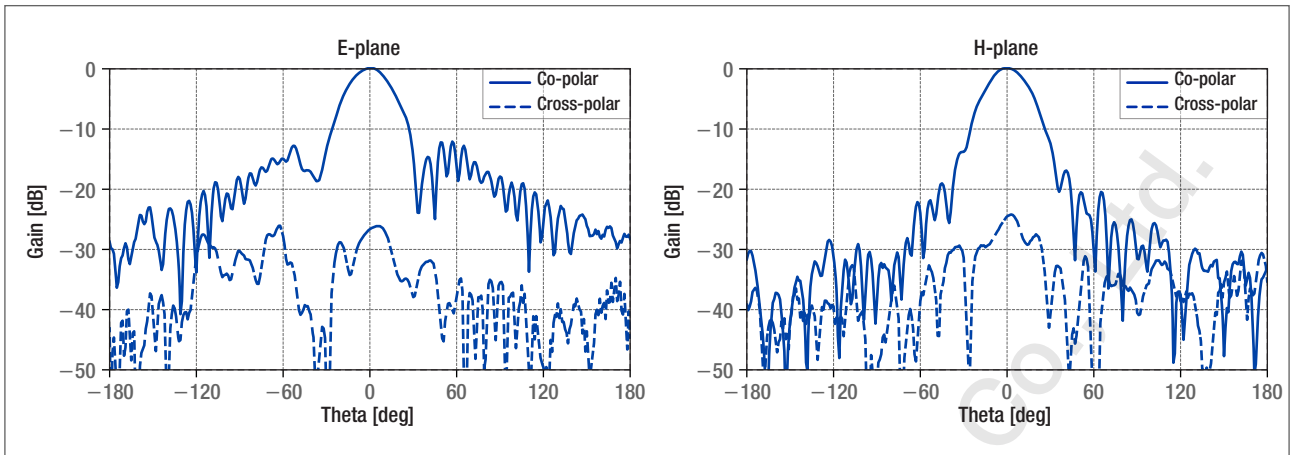

Patterns @ 33.0 GHz

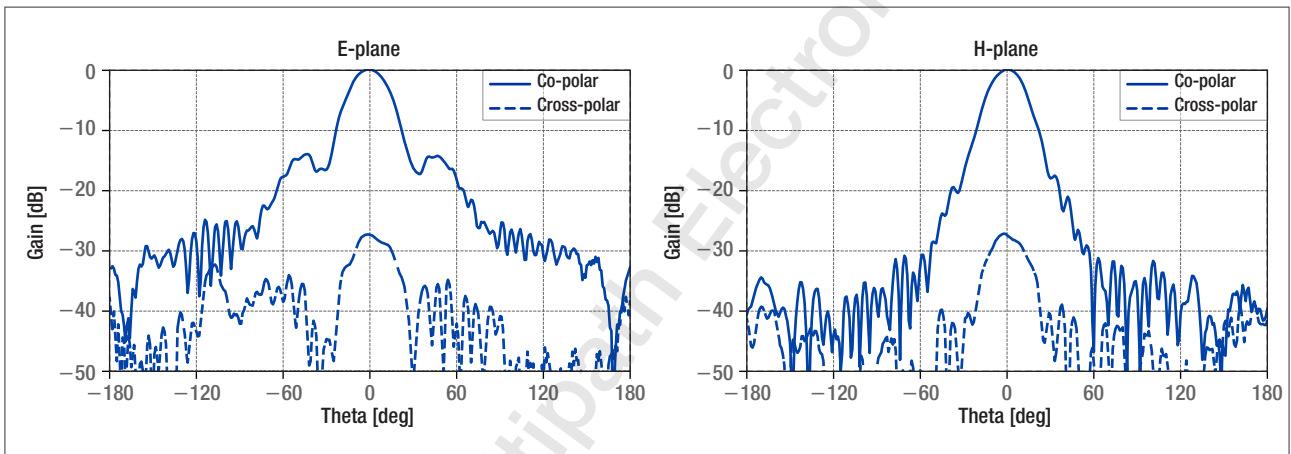

Patterns @ 39.5 GHz

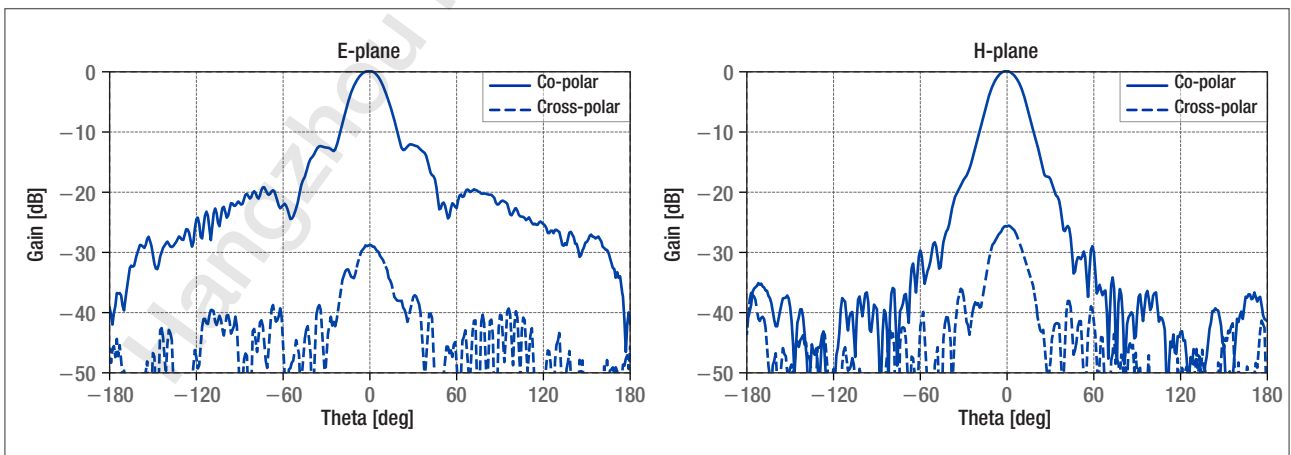

• Data table

Frequency [GHz]	Gain [dBi]	Antenna factor [dB/m]	Cross-polarization isolation [dB]	VSWR
26.5	14.93	43.74	-26.62	1.22
27.0	14.96	43.87	-26.32	1.13
27.5	15.00	43.97	-25.86	1.25
28.0	15.18	43.96	-26.53	1.30
28.5	15.48	43.82	-27.12	1.20
29.0	15.71	43.73	-26.55	1.13
29.5	15.90	43.70	-28.08	1.14
30.0	16.06	43.69	-27.94	1.12
30.5	16.13	43.75	-28.05	1.05
31.0	16.17	43.85	-28.15	1.13
31.5	16.27	43.90	-27.50	1.18
32.0	16.41	43.89	-27.41	1.09
32.5	16.59	43.85	-27.86	1.05
33.0	16.78	43.80	-27.30	1.12
33.5	16.95	43.75	-27.54	1.17
34.0	17.07	43.76	-27.17	1.23
34.5	17.15	43.80	-26.99	1.25
35.0	17.21	43.87	-27.70	1.13
35.5	17.29	43.92	-26.90	1.12
36.0	17.42	43.91	-25.10	1.22
36.5	17.60	43.85	-25.04	1.23
37.0	17.80	43.77	-26.30	1.19
37.5	17.96	43.72	-24.80	1.17
38.0	18.06	43.73	-25.54	1.15
38.5	18.08	43.83	-25.82	1.05
39.0	18.03	43.99	-27.36	1.12

Frequency [GHz]	E-plane, 3dB beamwidth	H-plane, 3dB beamwidth
26.5	29.10°	28.05°
33.0	25.98°	24.06°
39.5	22.06°	21.09°



Multipath Electronics

### Contact

+86-571-56201039

sales@multipath.cn

<https://www.multipath-electron.com>

Technical specifications in this datasheet are subject to change without notice. Actual products may differ from the shown images.