

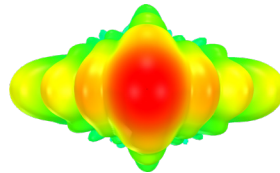

Standard Gain Horn Antennas

11.9 - 18.0 GHz, 20 dBi

Radiation pattern



QR code



Hangzhou Multipath Electronics Co., Ltd., Zhejiang, China

⚙️ Product specifications

Part number	HA-WR62-20	Polarization	Single linear
Antenna type	Pyamidal horn	Gain [dBi]	20 Typ.
Frequency range [GHz]	11.9 – 18.0	3dB beamwidth [deg]	E-plane: 14 Typ. H-plane: 16 Typ.
Waveguide band	WR62	Cross-polarization isolation [dB]	40 Typ.
Dimensions (H x W x L) [mm; inch]	94.0 x 74.0 x 173.99; 3.70 x 2.91 x 6.85	VSWR	1.25 Typ.
Weight (approx.) [kg; lb]	0.20; 0.441	Impedance [Ohms]	50
Material	Aluminum	RF connector	SMA-Female

Outline dimensions

• Assembly dimensional drawing

Multipath Electronics provides complete standard gain horn antennas, forming mounting systems, integrated with (optional) waveguide to coaxial adapters, L type and round mounting brackets. The following figure shows the disassembly diagram of such a system.

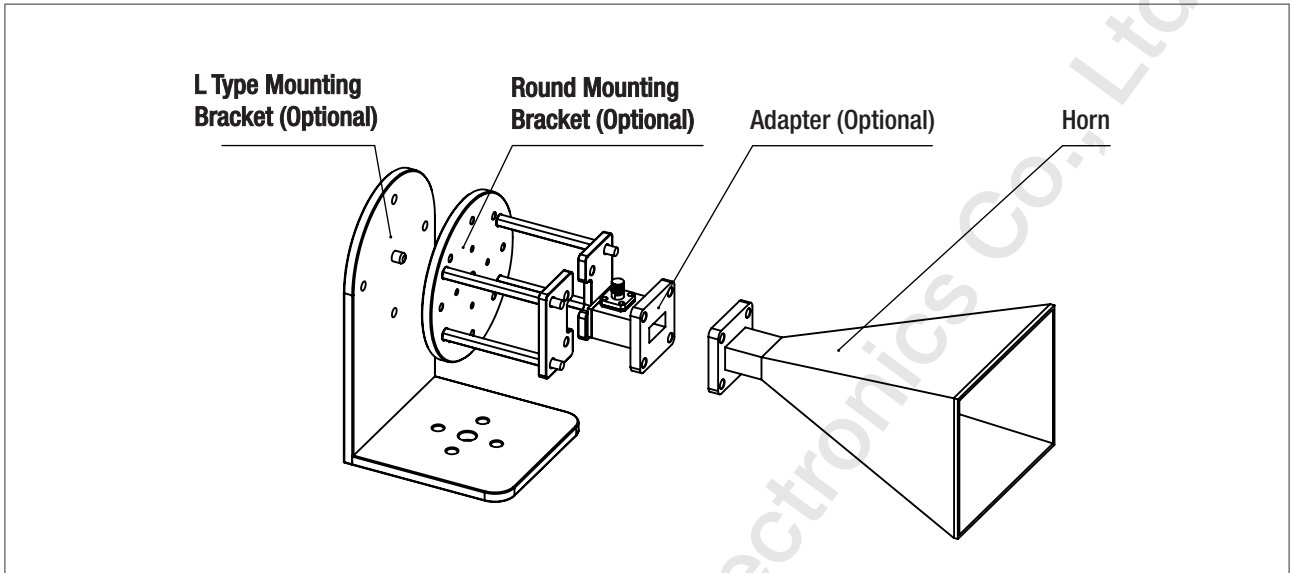

Side view of the mounting system.

Detailed dimensions of the components will be given in subsequent diagrams.

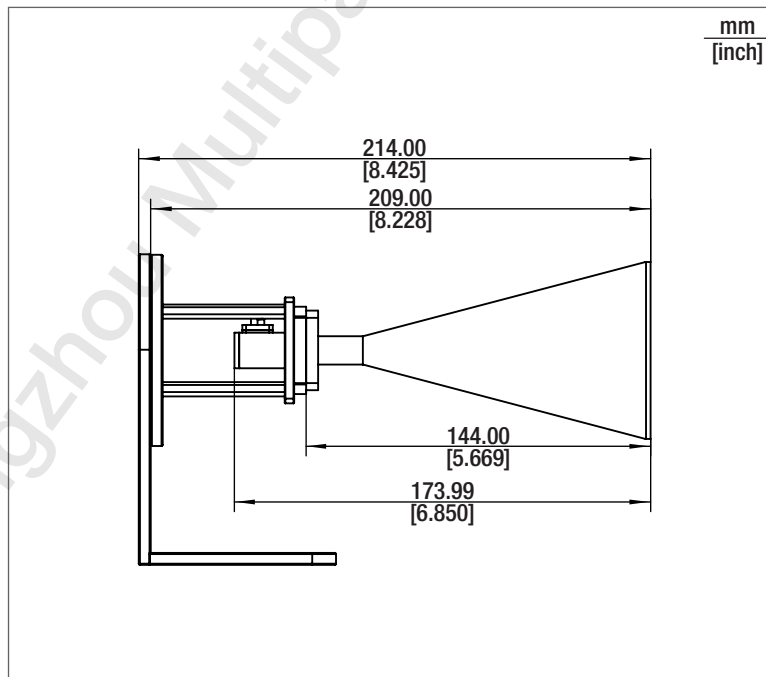

• Dimensional drawing: horn, HA-WR62-20

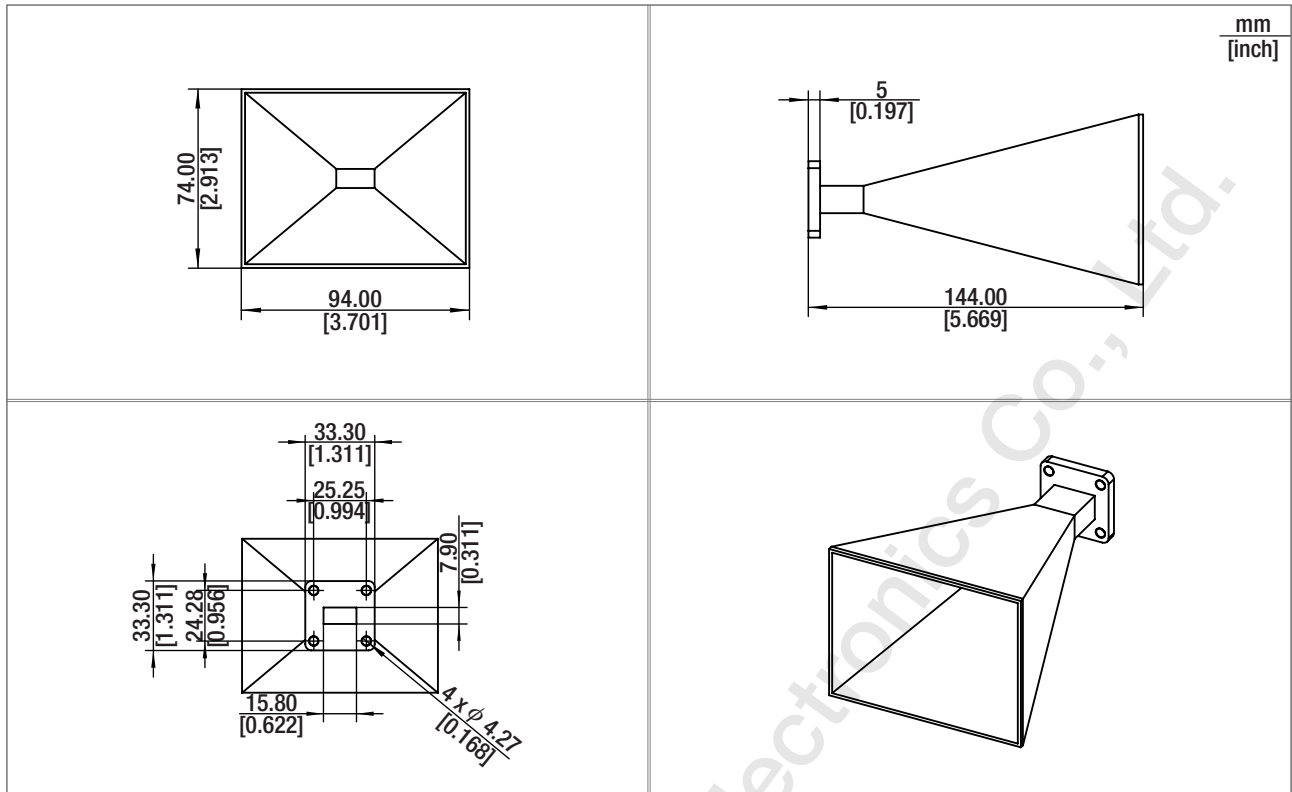

• Dimensional drawing: adapter, WR62-SMA-F (Optional)

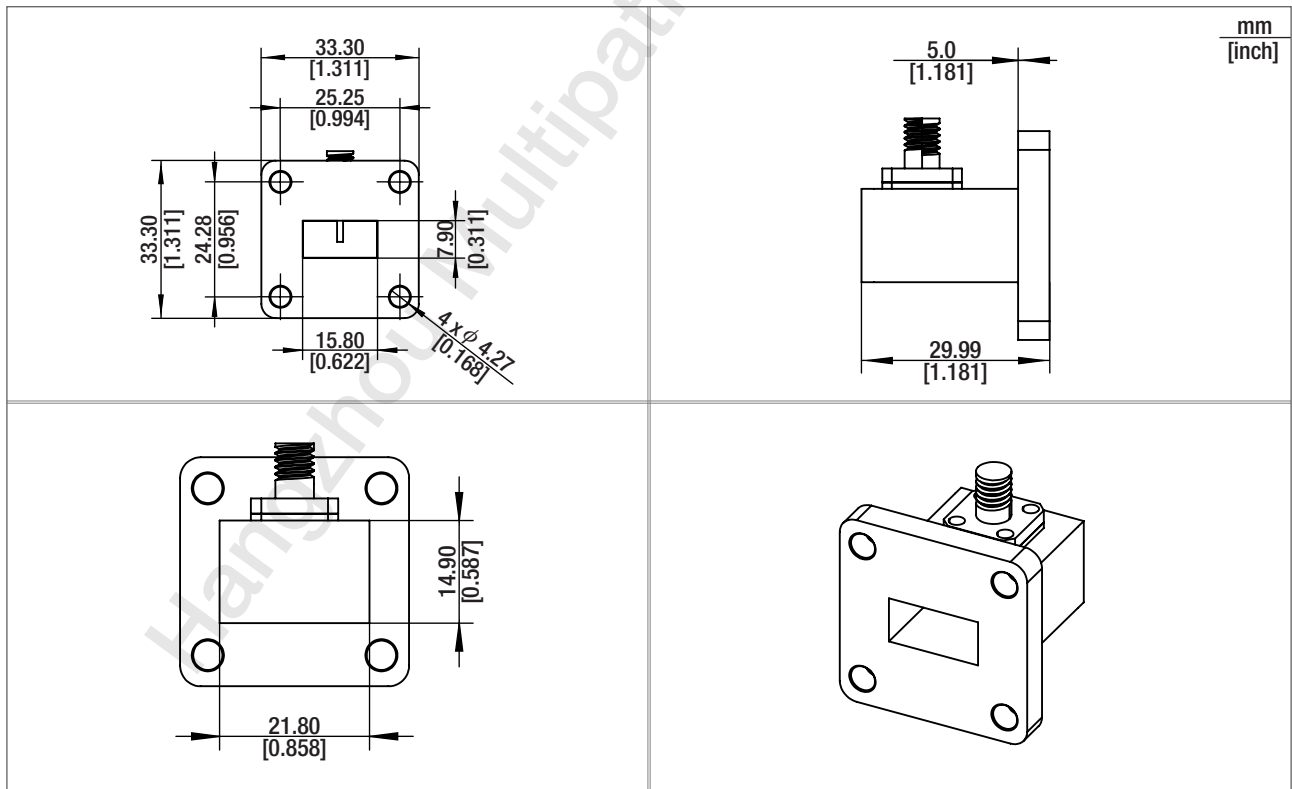

• Dimensional drawing: round mounting bracket (Optional)

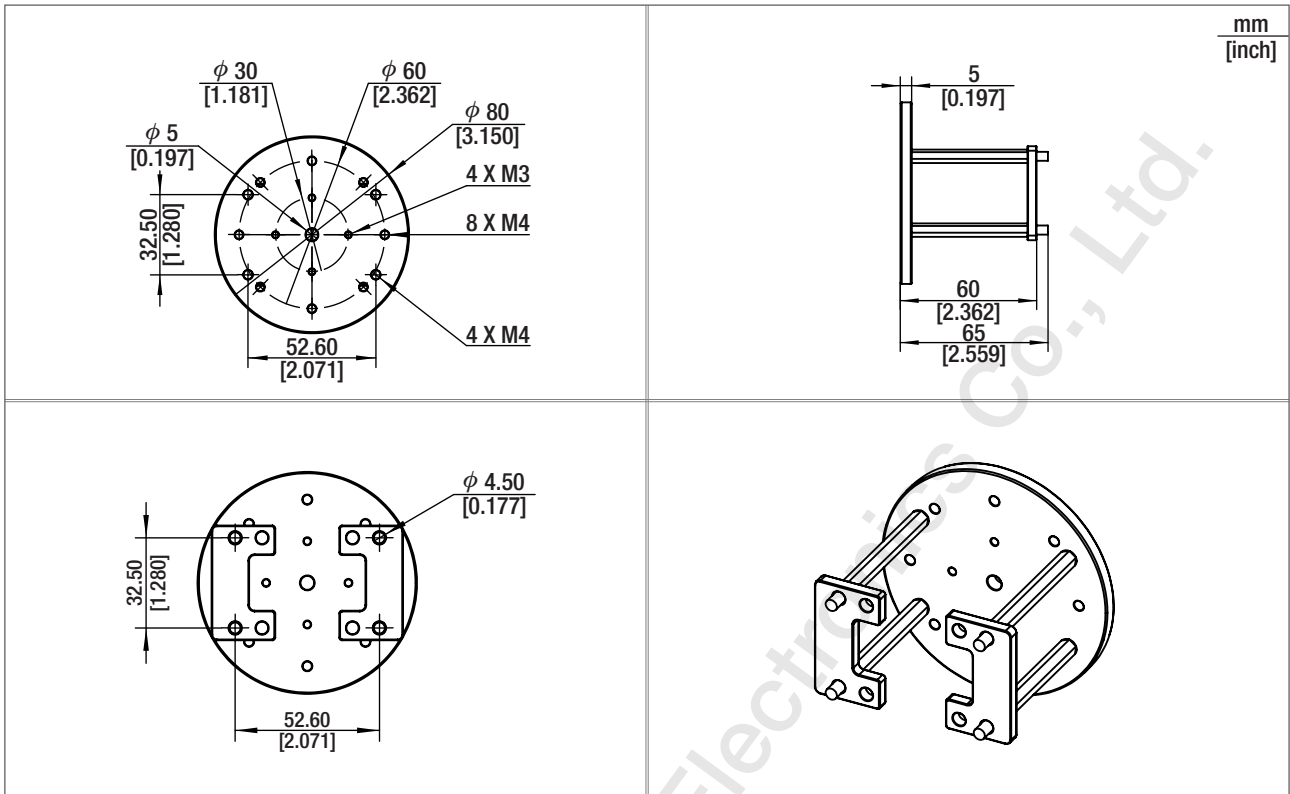

• Dimensional drawing: L type mounting bracket (Optional)

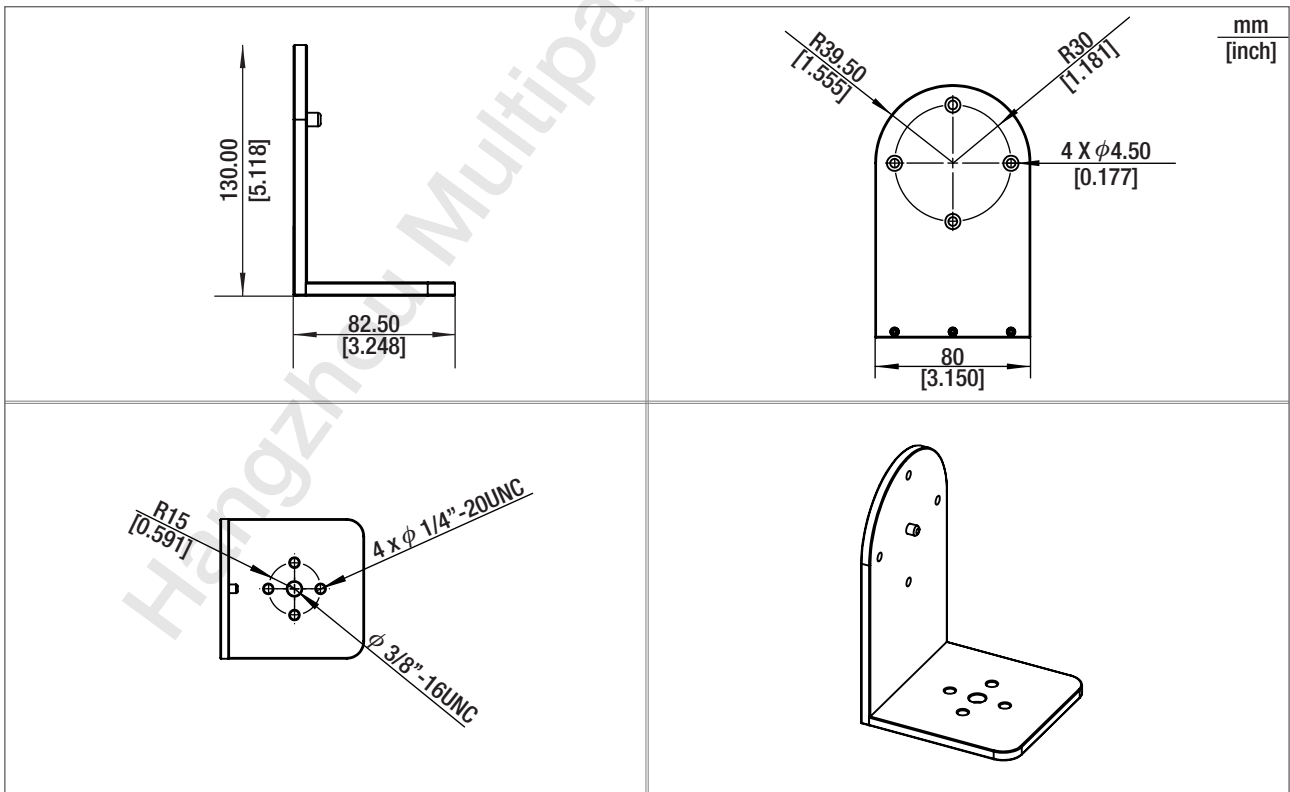

Electrical characteristics

Gain & Antenna factor & Cross-polarization isolation & VSWR

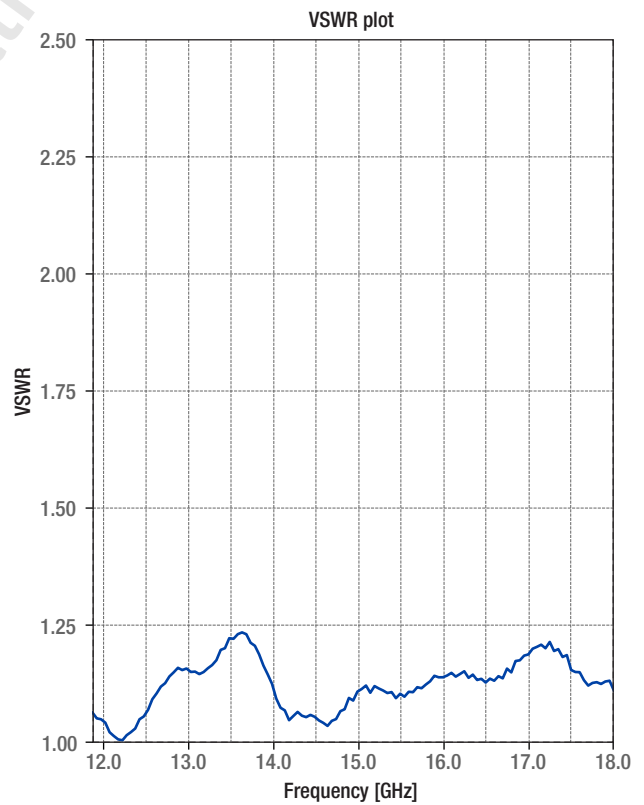
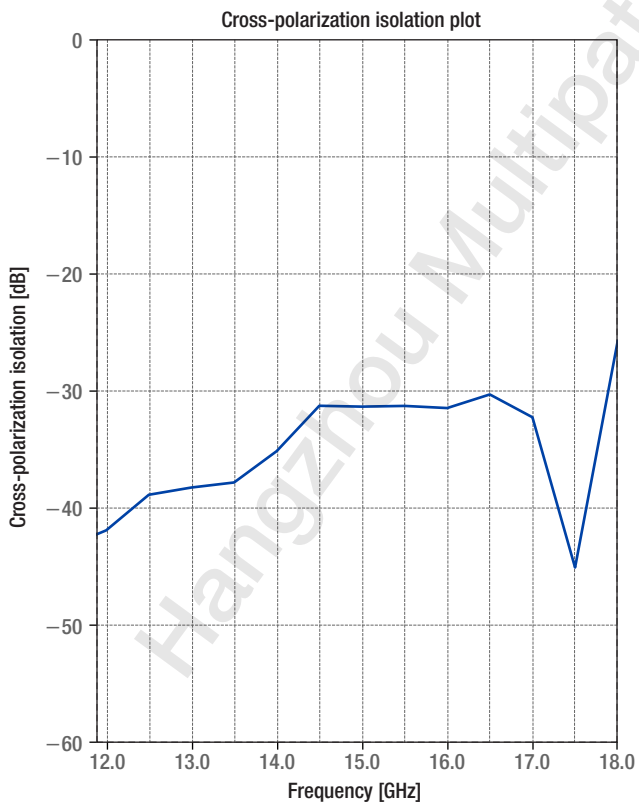
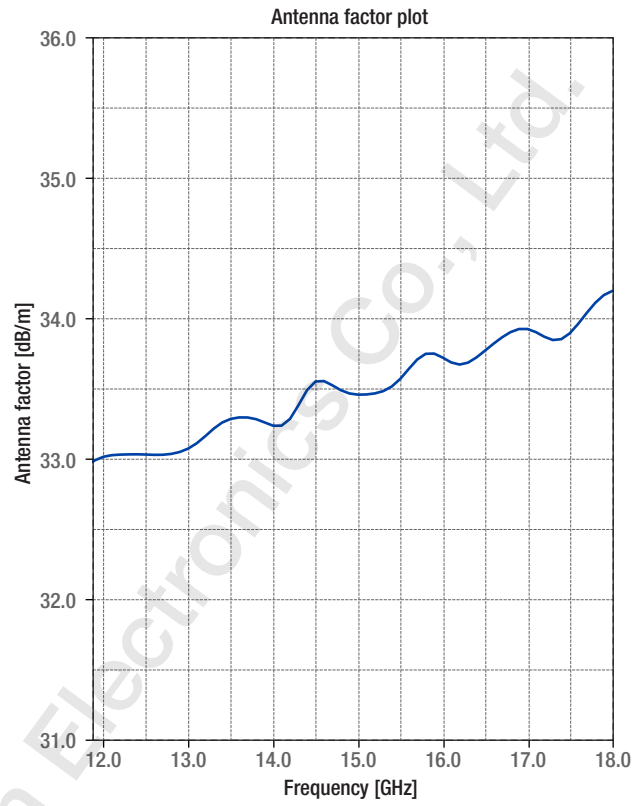
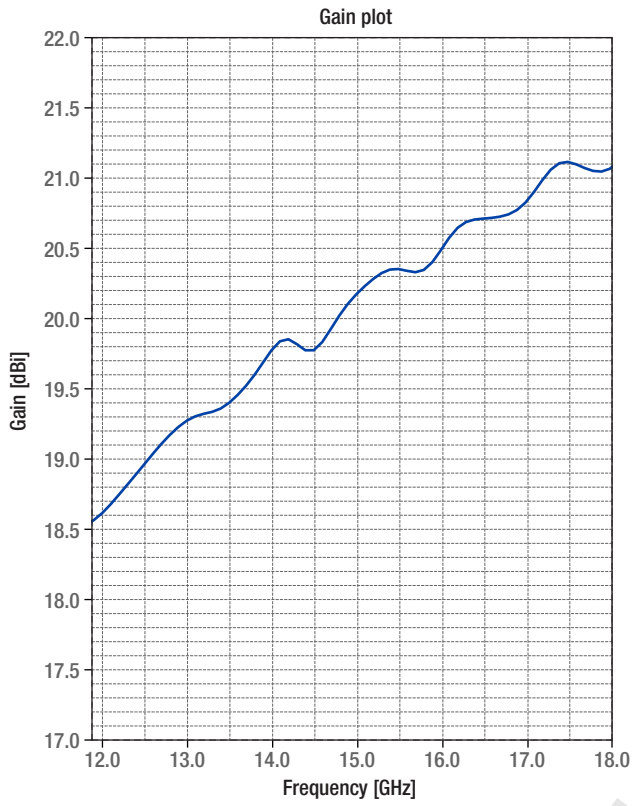

• Radiation patterns

Patterns @ 12.0 GHz

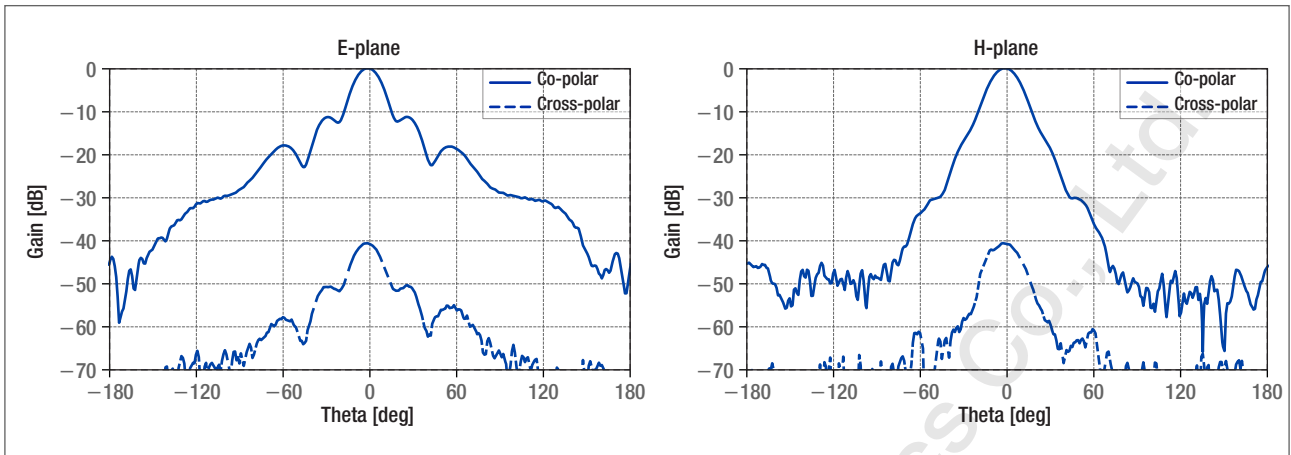

Patterns @ 15.0 GHz

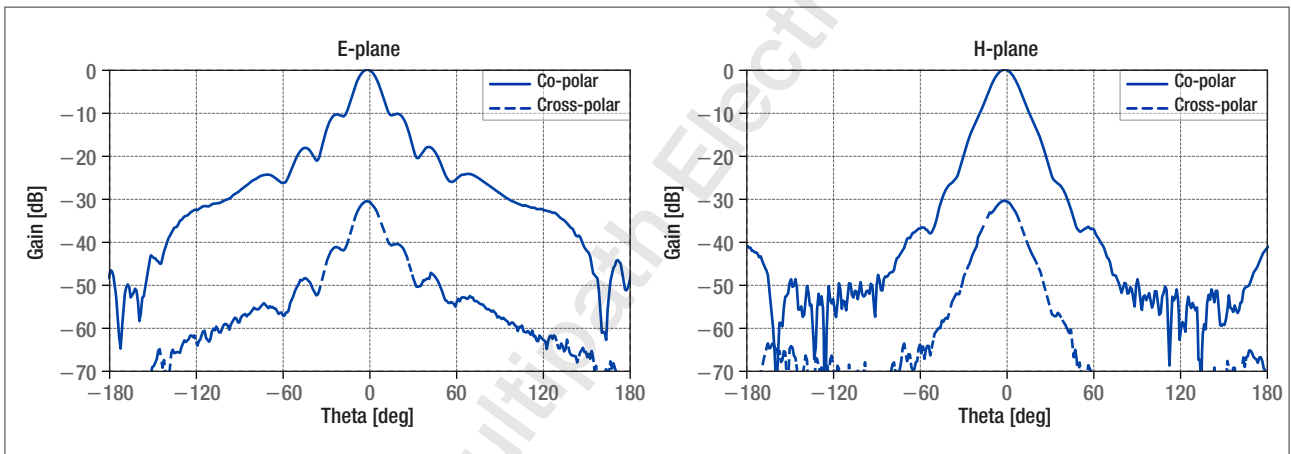

Patterns @ 17.0 GHz

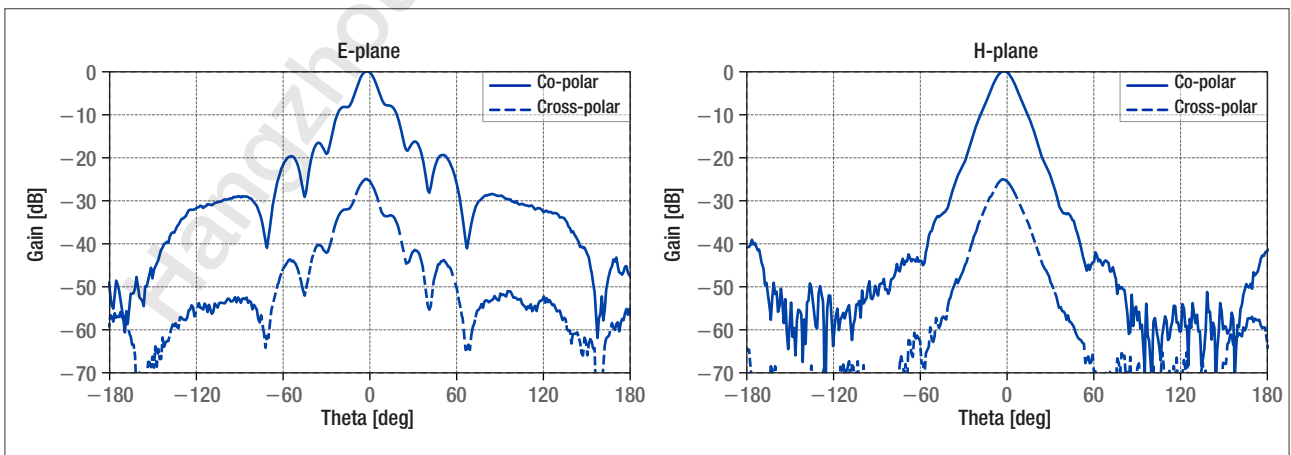

• Data table

Frequency [GHz]	Gain [dBi]	Antenna factor [dB/m]	Cross-polarization isolation [dB]	VSWR
12.0	18.71	33.06	-40.87	1.04
12.3	18.91	33.08	-39.11	1.01
12.6	19.12	33.08	-37.82	1.08
12.9	19.31	33.10	-37.46	1.15
13.2	19.40	33.21	-37.18	1.14
13.5	19.47	33.32	-36.93	1.21
13.8	19.66	33.32	-35.38	1.19
14.1	19.90	33.28	-33.60	1.07
14.4	19.83	33.52	-31.36	1.05
14.7	19.98	33.56	-30.65	1.04
15.0	20.22	33.49	-30.69	1.10
15.3	20.37	33.52	-30.65	1.10
15.6	20.38	33.67	-30.66	1.10
15.9	20.44	33.78	-30.77	1.13
16.2	20.68	33.70	-30.36	1.14
16.5	20.74	33.80	-29.68	1.12
16.8	20.77	33.92	-30.81	1.14
17.1	20.93	33.92	-34.03	1.19
17.4	21.13	33.87	-41.45	1.17
17.7	21.09	34.06	-36.47	1.11
18.0	21.09	34.21	-25.30	1.10

Frequency [GHz]	E-plane, 3dB beamwidth	H-plane, 3dB beamwidth
12.0	18.15°	19.97°
15.0	15.12°	17.00°
17.0	13.56°	15.30°



Multipath Electronics

Contact

-  +86-571-56201039
-  sales@multipath.cn
-  <https://www.multipath-electron.com>
-  Technical specifications in this datasheet are subject to change without notice. Actual products may differ from the shown images.