



# Standard Gain Horn Antennas

9.84 - 15.0 GHz, 10 dBi



Radiation pattern

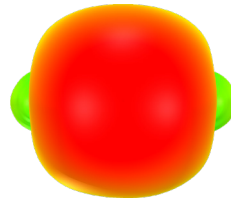

QR code



Hangzhou Multipath Electronics Co., Ltd., Zhejiang, China

## ⚙️ Product specifications

Part number	HA-WR75-10	Polarization	Single linear
Antenna type	Pyamidal horn	Gain [dBi]	10 Typ.
Frequency range [GHz]	9.84 – 15.0	3dB beamwidth [deg]	E-plane: 46 Typ. H-plane: 42 Typ.
Waveguide band	WR75	Cross-polarization isolation [dB]	30 Typ.
Dimensions (H x W x L) [mm; inch]	38.0 x 38.0 x 85.93; 1.50 x 1.50 x 3.38	VSWR	1.25 Typ.
Weight (approx.) [kg; lb]	0.10; 0.220	Impedance [Ohms]	50
Material	Aluminum	RF connector	SMA-Female

Outline dimensions

• Assembly dimensional drawing

Multipath Electronics provides complete standard gain horn antennas, forming mounting systems, integrated with (optional) waveguide to coaxial adapters, L type and round mounting brackets. The following figure shows the disassembly diagram of such a system.

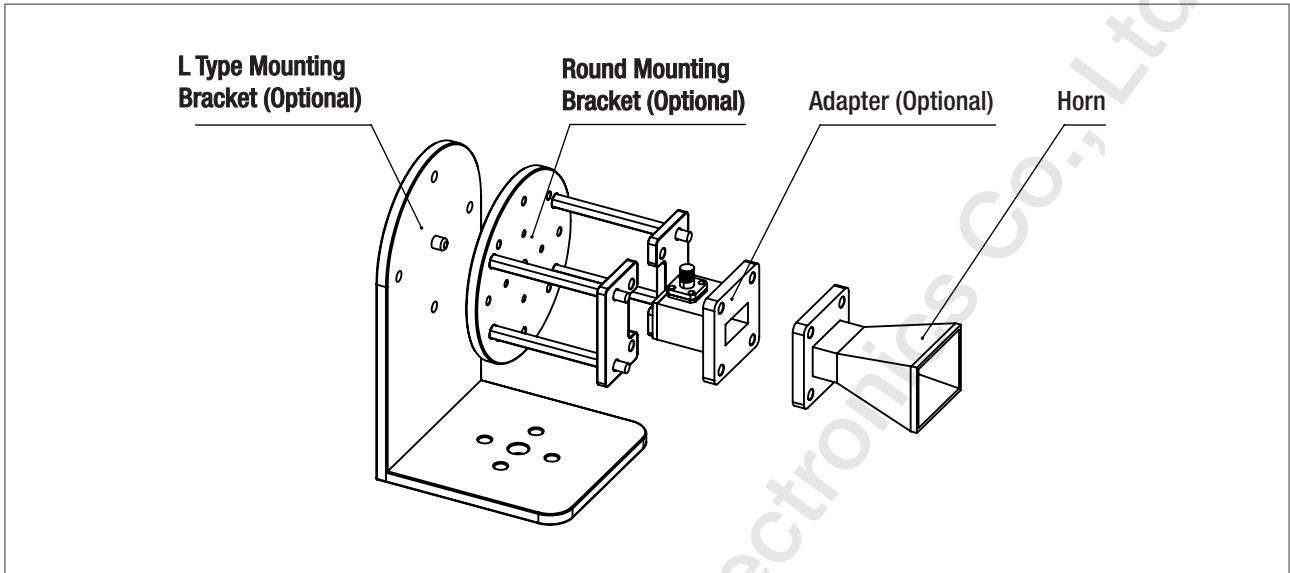

Side view of the mounting system.

Detailed dimensions of the components will be given in subsequent diagrams.

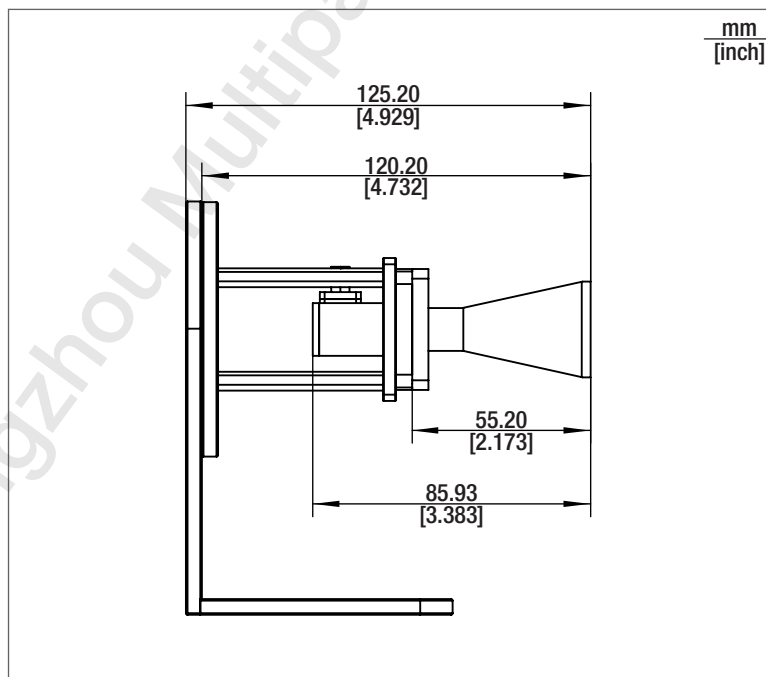

• Dimensional drawing: horn, HA-WR75-10

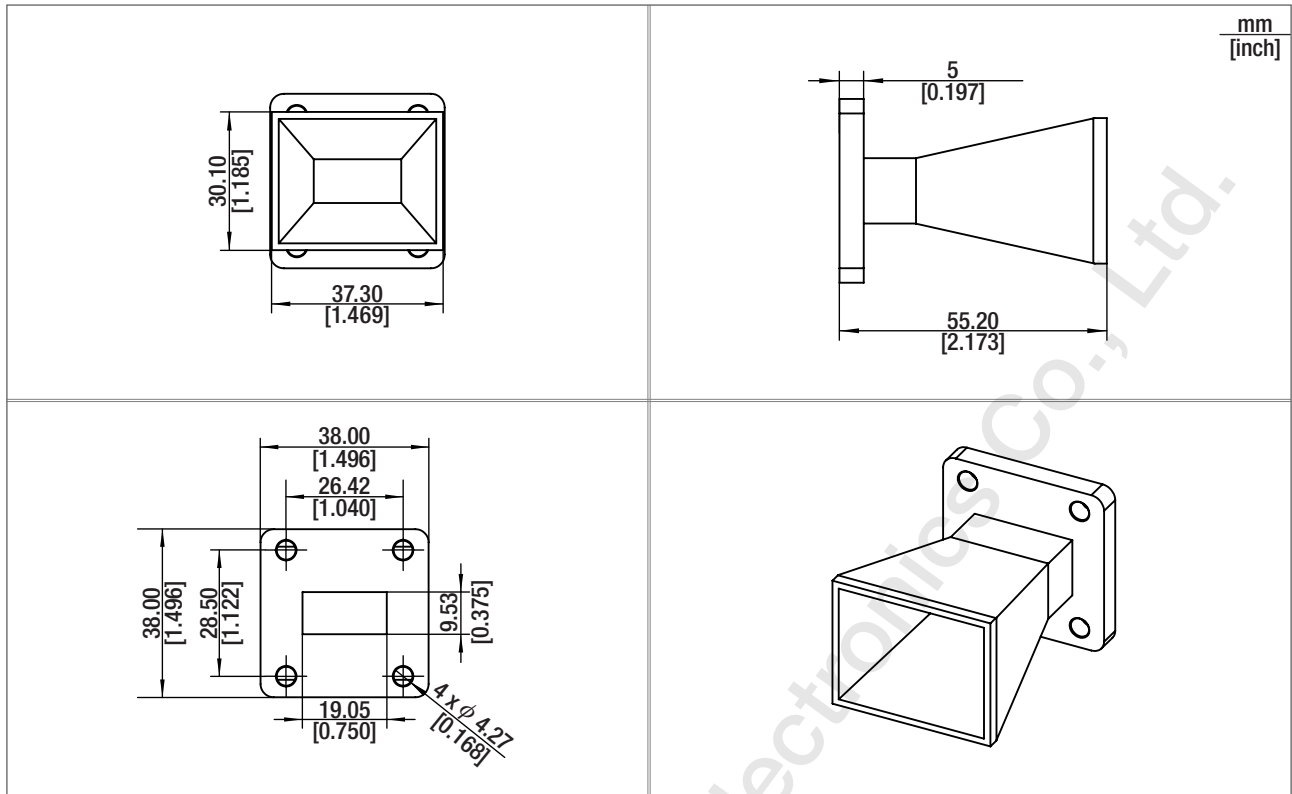

• Dimensional drawing: adapter, WR75-SMA-F (Optional)

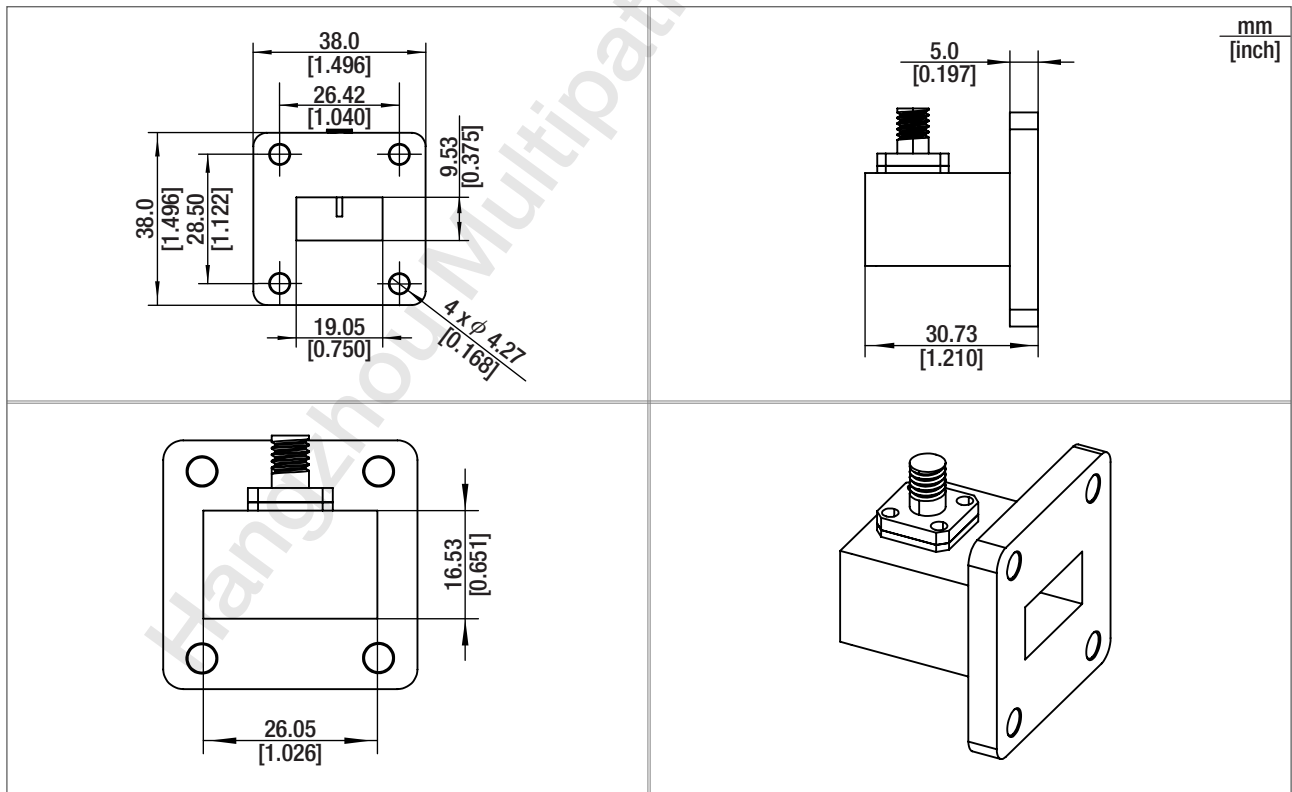

• Dimensional drawing: round mounting bracket (Optional)

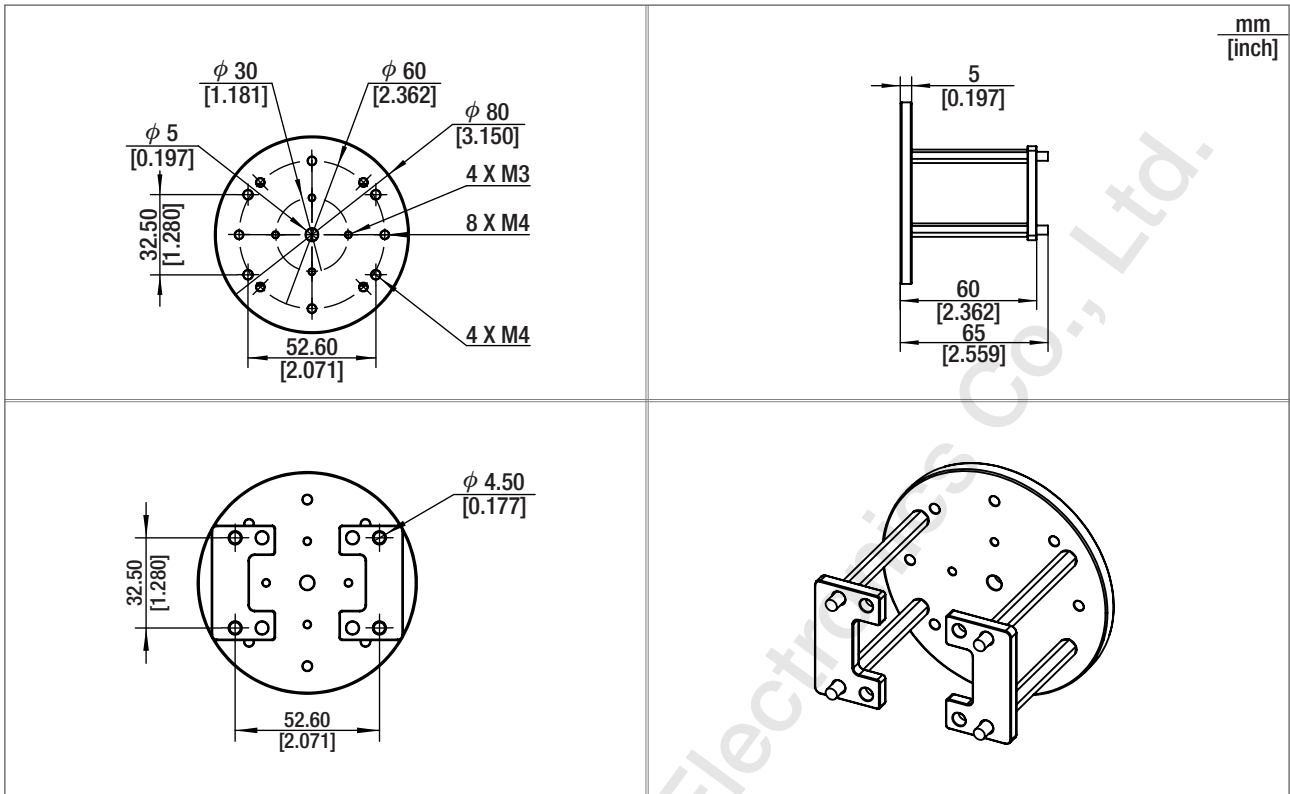

• Dimensional drawing: L type mounting bracket (Optional)

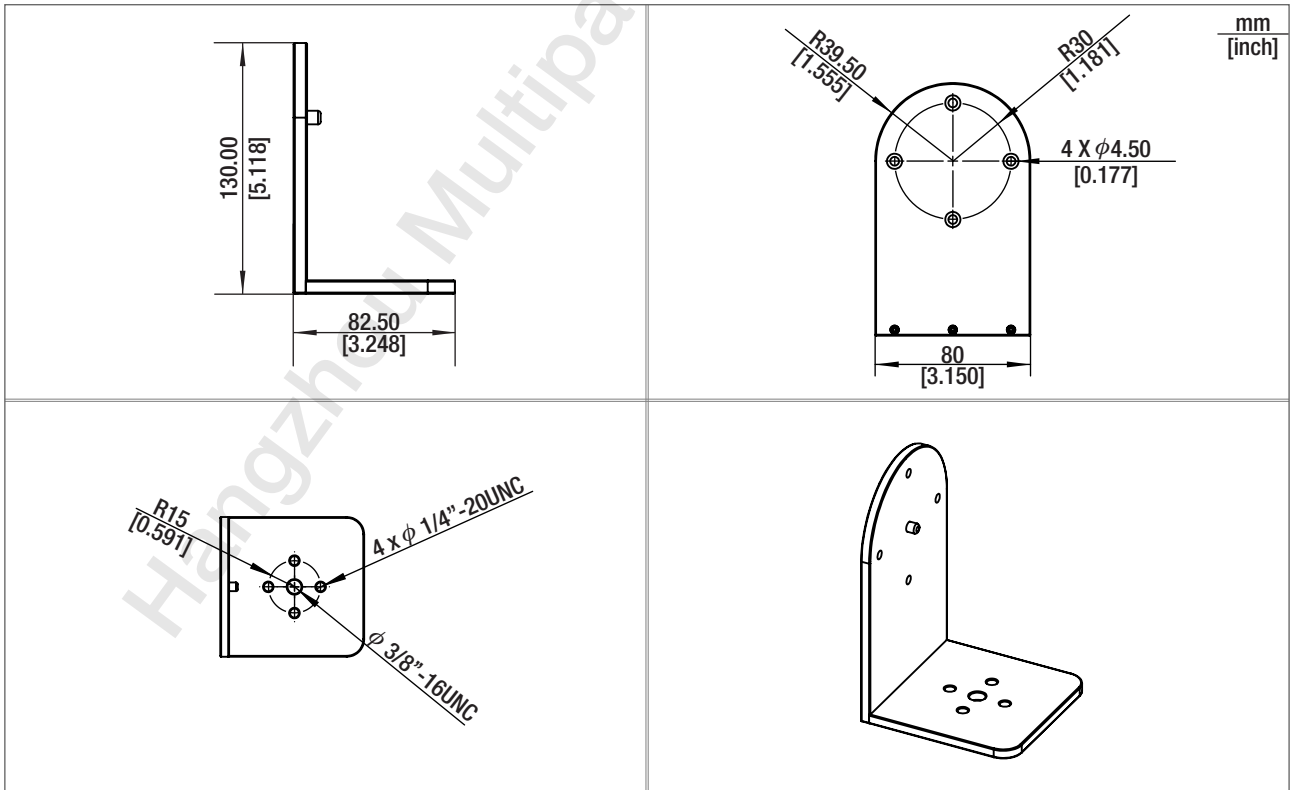

## Electrical characteristics

### Gain & Antenna factor & Cross-polarization isolation & VSWR

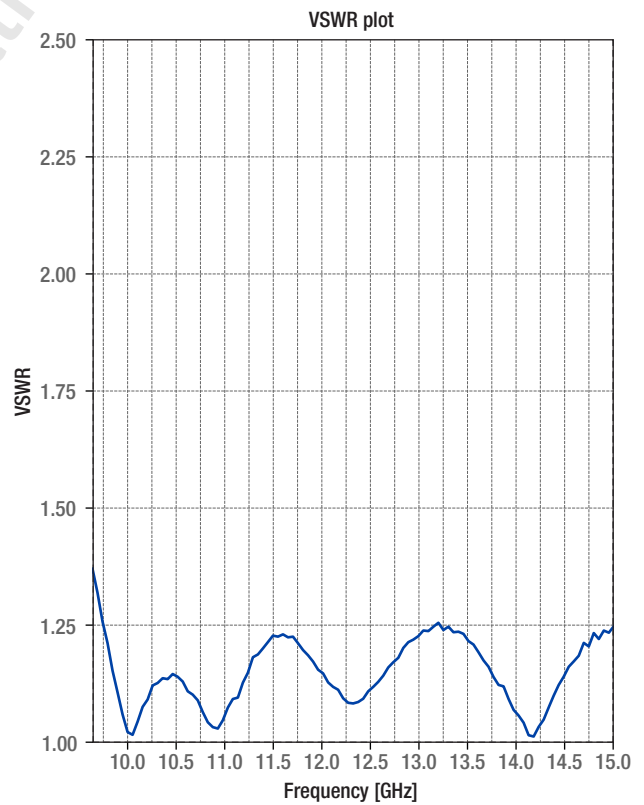
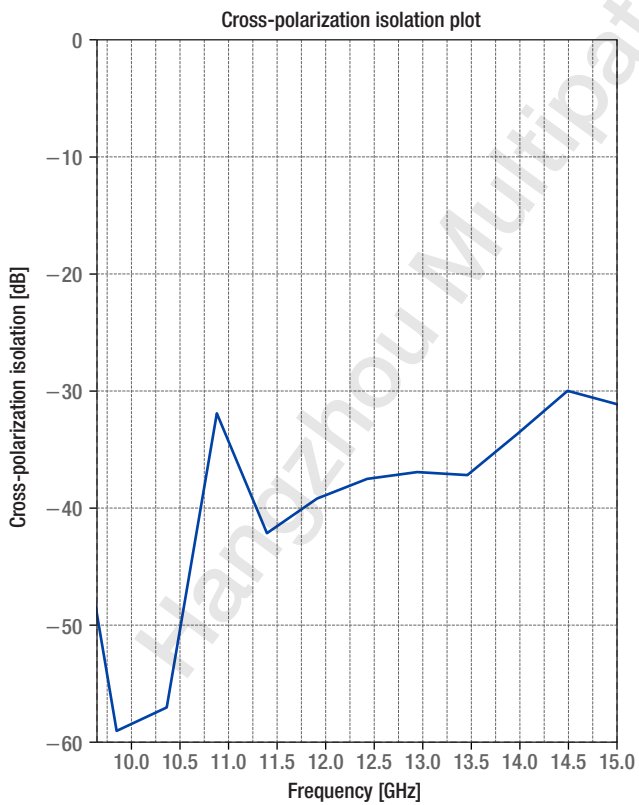
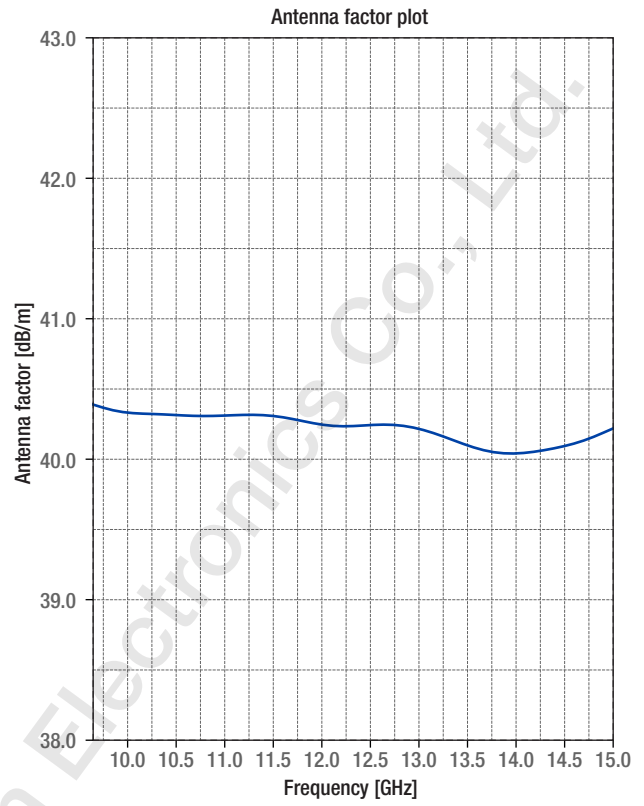
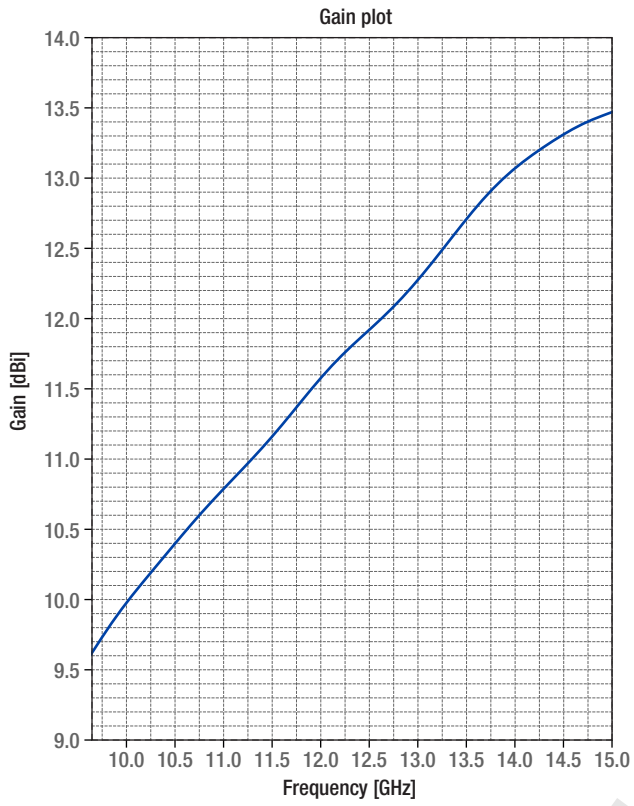

## • Radiation patterns

Patterns @ 10.0 GHz

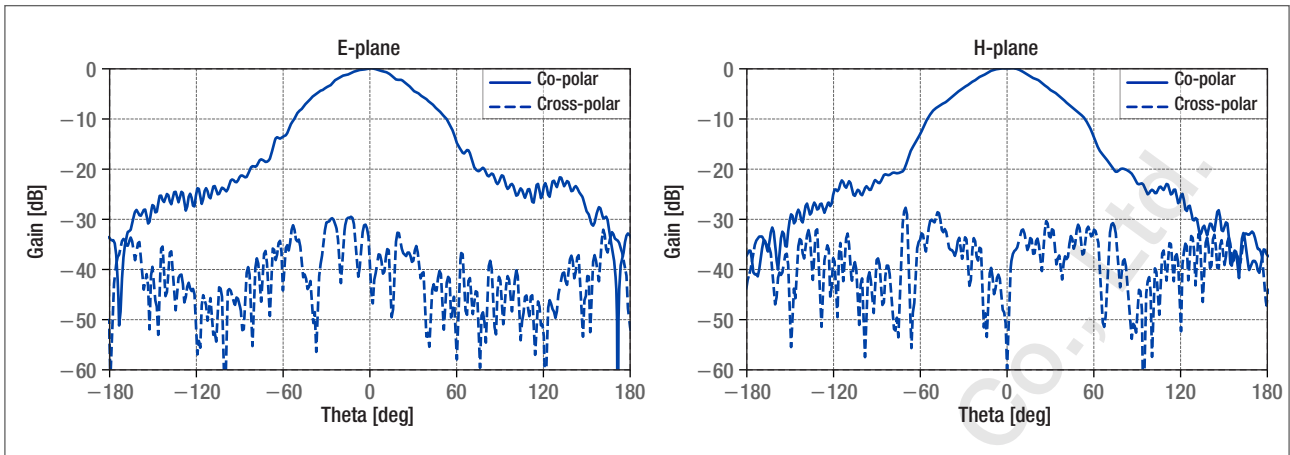

Patterns @ 12.0 GHz

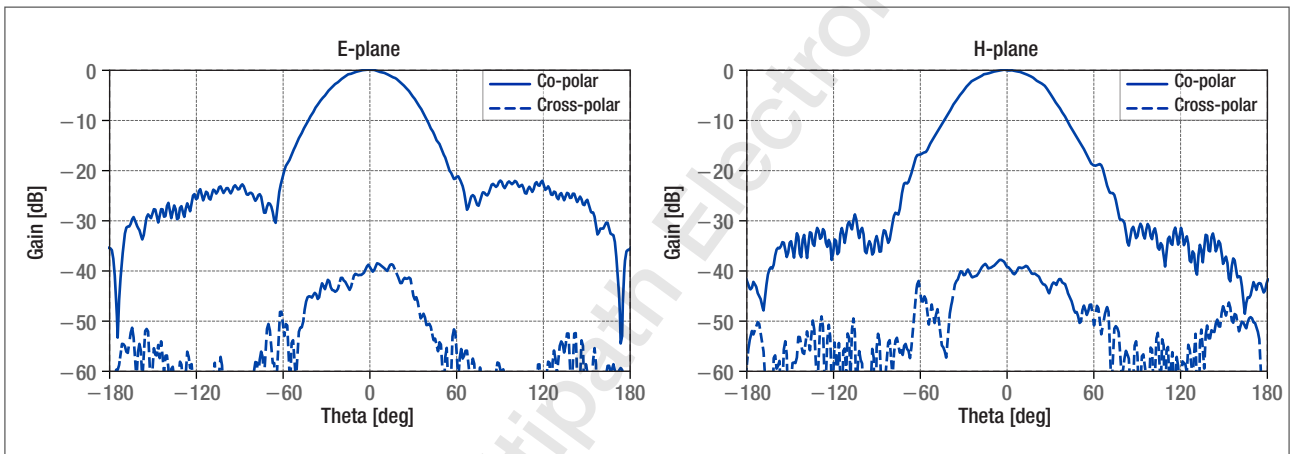

Patterns @ 15.0 GHz

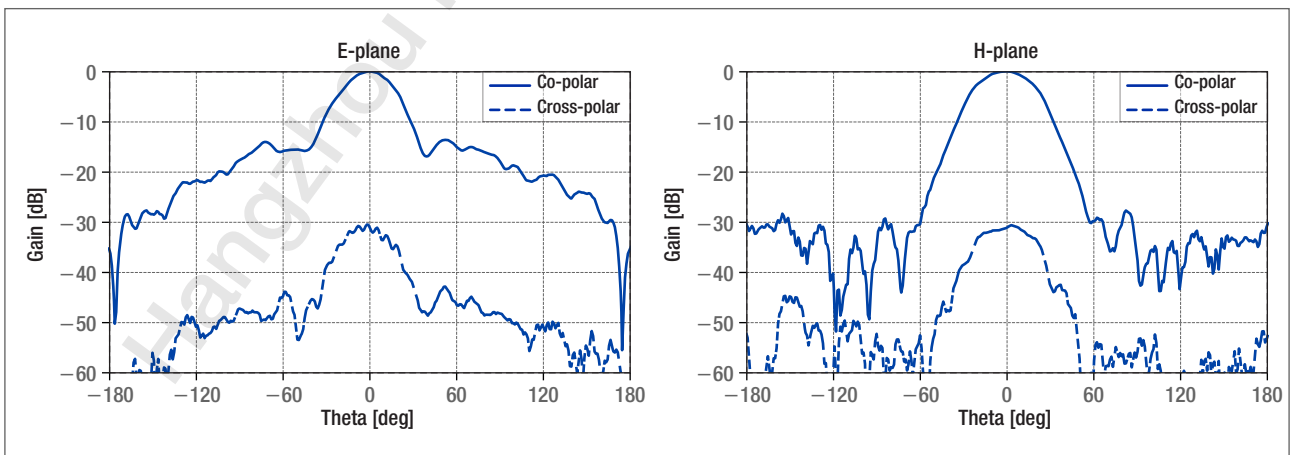

• Data table

Frequency [GHz]	Gain [dBi]	Antenna factor [dB/m]	Cross-polarization isolation [dB]	VSWR
10.0	9.83	40.36	-58.97	1.15
10.3	10.12	40.33	-57.77	1.07
10.6	10.37	40.32	-51.92	1.14
10.9	10.62	40.31	-36.81	1.06
11.2	10.85	40.32	-35.87	1.09
11.5	11.08	40.32	-42.03	1.20
11.8	11.34	40.29	-40.25	1.22
12.1	11.59	40.25	-38.73	1.14
12.4	11.82	40.24	-37.72	1.08
12.7	12.01	40.25	-37.15	1.14
13.0	12.24	40.23	-36.80	1.22
13.3	12.50	40.17	-36.95	1.24
13.6	12.77	40.09	-36.35	1.21
13.9	13.00	40.05	-34.23	1.12
14.2	13.18	40.06	-32.05	1.01
14.5	13.32	40.10	-29.84	1.14
14.8	13.43	40.17	-30.54	1.23

Frequency [GHz]	E-plane, 3dB beamwidth	H-plane, 3dB beamwidth
10.0	51.32°	51.15°
12.0	48.17°	50.48°
15.0	32.47°	41.55°



Multipath Electronics

**Contact**

+86-571-56201039

sales@multipath.cn

https://www.multipath-electron.com

Technical specifications in this datasheet are subject to change without notice. Actual products may differ from the shown images.